



SUPERMAN HOISTS – 5 Tonne SWL
4.0m x 3.0m x 2.6m
5.0m x 3.0m x 2.6m – Special Order
OPTIONAL – with one or two XL Builders Hoists



+61 2 9426 9700 mel@fowlerformwork.com.au www.fowlerformwork.com.au

1333 The Horsley Drive WETHERILL PARK NSW 2164

SUPERMAN HOIST WITH OPTIONAL SINGLE XL HOIST

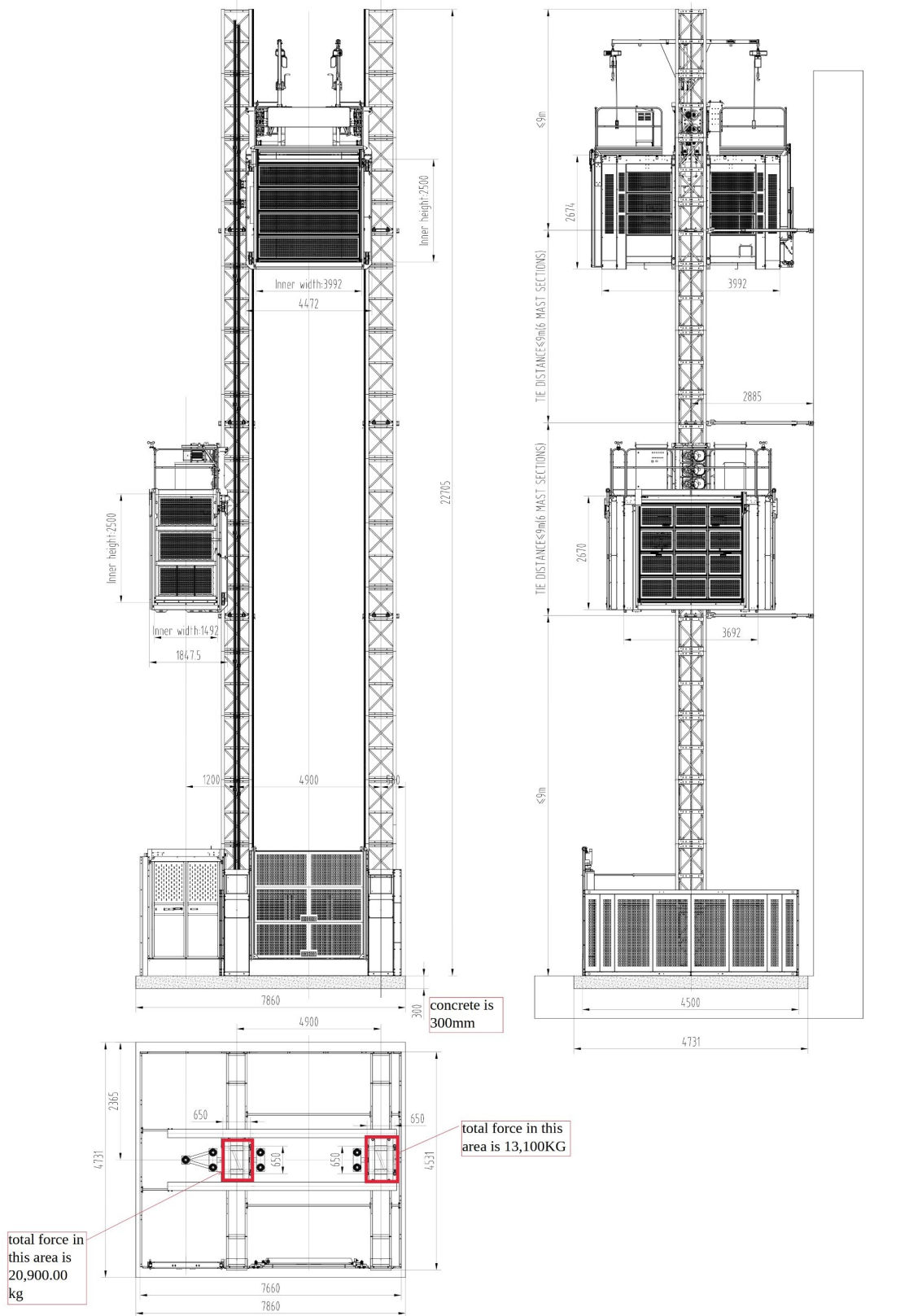

SUPERMAN HOIST WITH OPTIONAL DOUBLE XL HOIST

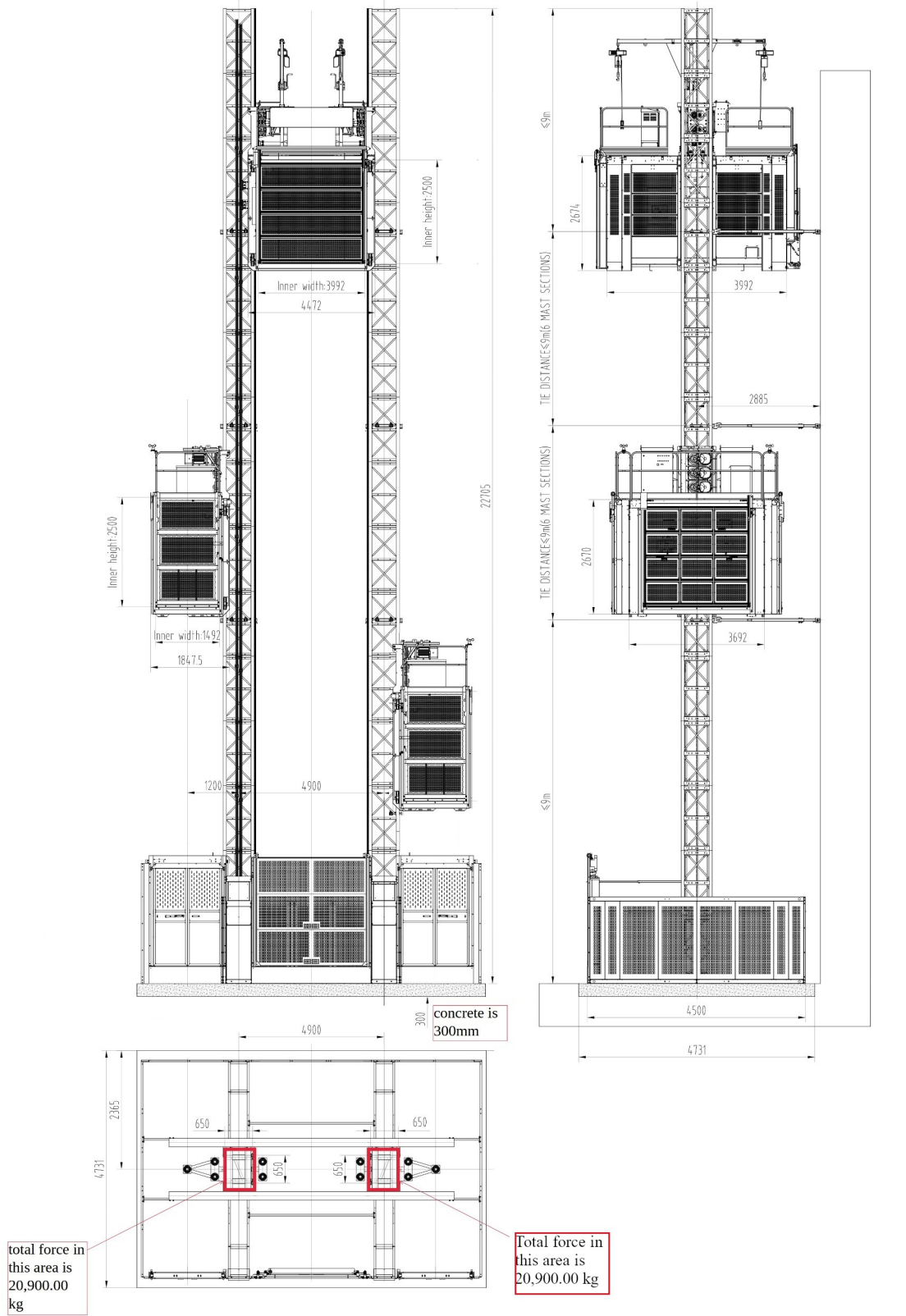

OPTIONAL WIDE CAGE HOISTS - x1 OR x2

FBH650 XL Series Builder's Hoist

Main technical parameter	Unit	Parameter values
		SC300-65
car with two single way lift up doors	kg	3000
Payload (Instl./Dismtl.)	kg	1000
Cage size(LxW xH) (inner)	m	4.6 x 2.0 x 2.3 / 2.5 / 2.8
Erection crane payload	kg	170/250
Max. mast height	m	200 (4.5mm) ~ 500 (4.5 + 6.0mm)
Lifting Speed (Normal)	m/min	96
Lifting Speed (Instl./Dismtl./Inspt.)	m/min	9
Motor power	kW	3×38
Power supply voltage	V	415
Control voltage / frequency	V/Hz	110/50,60
Rated motor current	A	120
Max. starting current	A	180
Power fuses (single/twin)	A	200/400
Outlets for portable tools	V/A	220/10
Protection class	/	IP55
Safety device type		SAJ60-2.0
Calibrated tripping speed	m/s	1.95
Mast section weight (single/twin)	kg	119/135
Mast section size	mm	650 x 650 x 1508
Rack modular	mm	5
Cable guiding device		Cable collection basket (≤ 60m), vertical contact slip line, cable trolley on mast tubes, cable trolley on separate guide rail.
Cage door		Vertical entrance door in one part, exit door in two parts manual folding load ramp door, vertical side door in one part
Ground enclosure	Cage length 4.6m	Weight (single/dual) : 619/818 kg
Base frame	Cage length 4.6m	Weight (single/dual) : 350/430 kg
Cage	Cage length 4.6m	Weight (Excluding cable) : 2756 kg
Please use full type code for product description, the example of full type code SC250/250-65-FC-MS		
SC	: Product category Rack and pinion builder hoist.	
250	:Rated load for single cage machine.	
250/250	:Rated load for twin cage machine.	
65	:Center distance of mast tubes 65: 650× 650mm;;	
FC	:Frequency control.	
LS	:Low speed (≤40m/min;) MS—Middle speed (40 ~ 70m/min) ; HS—High speed (> 70m/min)	

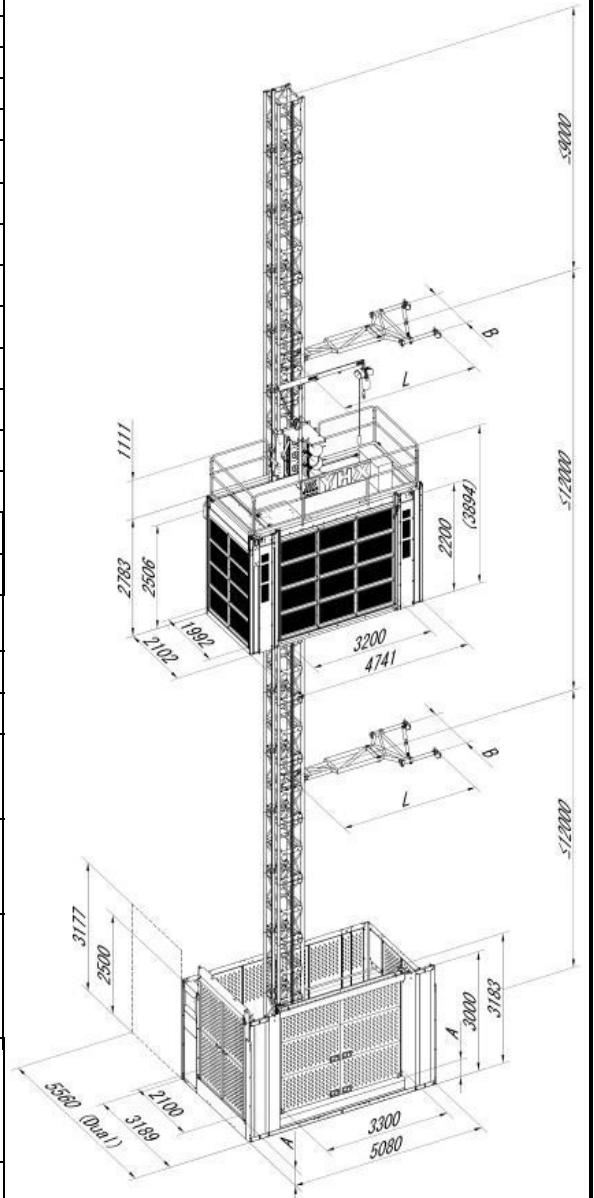

400 :For the hoist with cable basket Cable trolley on separate guide rail or contact slip line.
 950 :For the hoist with cable trolley on mast tubes or Oil buffer.
 2777 :For 2500m inner height cage.
 2077 :For 2.8m inner height cage.
 L=1990 ~ 2190 B=550 (3.2m cage L).
 L=234 ~ 02540 B=550 (3.9m cage L).
 L=2690 ~ 2890 B=550 (4.6m cage L).